

ATS&R



Wredling Middle School Community Meeting

May 13, 2008

Agenda...

- Introduction
- Approach to Evaluation
- Building utilization review
- Small group activity
- Reporting / Prioritization

ATS&R Background- School Specialists

- 63 Years as school specialists
- 98% of workload is PreK-12 schools
- Staff of 84 with in-house services:
 - Pre-Referendum Planning
 - Facilities Master Planning
 - Architectural
 - Mechanical/ Electrical
 - LEED Certification
 - Technology
 - Site Development
 - Construction Administration
 - Interior Design
 - Specifications/ Quality Control
 - Total Energy Checkpoint
- National Exposure
 - School Experience Nationally and Internationally
 - CEFPI-AASA-ASBO-NSBA-ITTE-CSI-NASSP
 - Recognized Presenters/Authors



District 303 Vision Statement

C.U.S.D 303
St. Charles School District

“The District 303 School Community empowers and inspires ALL to

- Attain excellence
- Learn with passion, and
- Live with integrity in a changing world.”

Agenda...

- Introduction
- **Approach to Evaluation**
- Building utilization review
- Small group activity
- Reporting / Prioritization

Approach to Evaluation

- Comprehensive assessment of all schools
- Community group involvement
- Developing a Master Facilities Plan

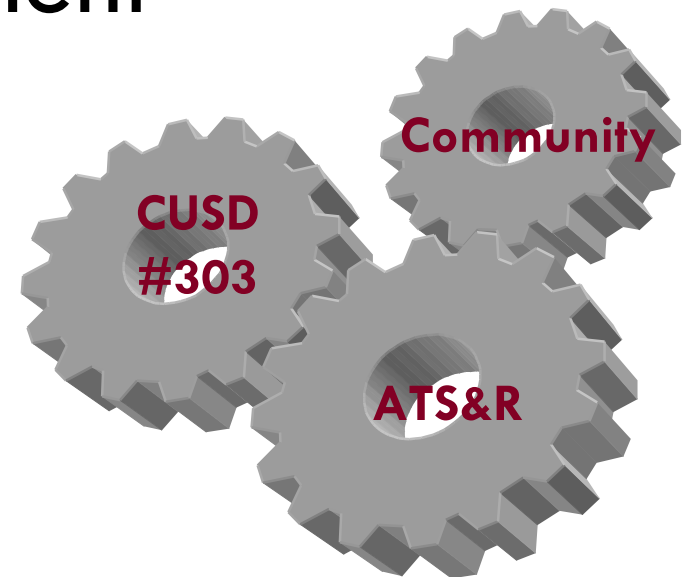

St. Charles North High School

Develop a Master Facilities Plan

Providing a solid foundation for the Master Plan

- Supported by the assessment and community engagement process
- Responds to research on demographics, space, etc.
- Open, honest communication with the community
- Guide for planning and improvement projects for the next 20 years



STANDARDS – Middle Schools



ROOM SIZES	Min	High					Notes
Classrooms	900	950	20	-	28	students	
Special Education							
Small Group	450		5	-	8	students	
Classroom	800						
Lab	1,200						
Science	1,200	1,500					
Classroom / Lab	1,200	1,400			24	students	
Storage / Lab prep	300						
Art	1,200	1,500					
Multi / Paint / Drawing Lab	1,200	1,500	20	-	28	students	plus storage
3D - Ceramics / Clay lab	1,500						plus clay / kiln / stor
FACS	1,200	1,500	20	-	24	students	
Classroom / Lab	1,200	1,500					
Technical Education	1,200	1,500					
Tech Lab	1,800	2,400			25	students	plus storage
CADD / Graphics	1,400	1,800					plus storage
General Shop	2,000	3,000					plus storage
Music (General)	1,000	1,500					
General	1,000	1,200					
Instrumental	1,500	2,700					
Choral	1,200	2,000					
Physical Education (PE)	6,000	7,000					
Multipurpose room	1,700						
Weights / Fitness	2,000						
PE storage	300						per station
Learning Resource Center							
Reading (w/ comp. resource)	5,000	5,800	1000	-	1200	students	
Support	600						
Computer Lab	1,000	1,300	20	-	30	students	
Food Service							
Dining	3,300	4,500	1000	-	1200	students	4 periods
Kitchen	1,500	2,500					serving - prep
Support	1,600	1,700					
Student Services (Admin / Staff)	4,000	5,000	1000	-	1200	students	
Resource / Support							
Small Group	150	200	5	-	10	students	
Large Group	600	1,500	60		125	students	

SITE SIZES	Min	High				
Site (acres) 20 +1/100 students	30	32	1000	-	1200	students
Site (acres) 25-35 +1/100 students (plus ROW, wetlands, retention, on site water or septic systems)	35	47	1000	-	1200	students

EXPECTATIONS - All Schools

Safety:

Clear separation of bus / staff / visitor / walker site circulation
Site lighting

Security:

Active / passive systems
Controlled access entry / community use zone (s)

Accessibility:

ADA access to all teaching stations, community, staff areas
Appropriate special services rooms

Building:

Natural light to Classrooms
Appropriate type / size of teaching stations (Flexibility)
Core capacity to match building capacity

Ventilation:

Code required (+/- 12-15) CFM per person

Electrical:

Properly sized electrical to support needs of site and building

Technology:

Appropriate Voice / Video / Data systems

Agenda...

- Introduction
- Approach to Evaluation
- **Building utilization review**
- Small group activity
- Reporting / Prioritization

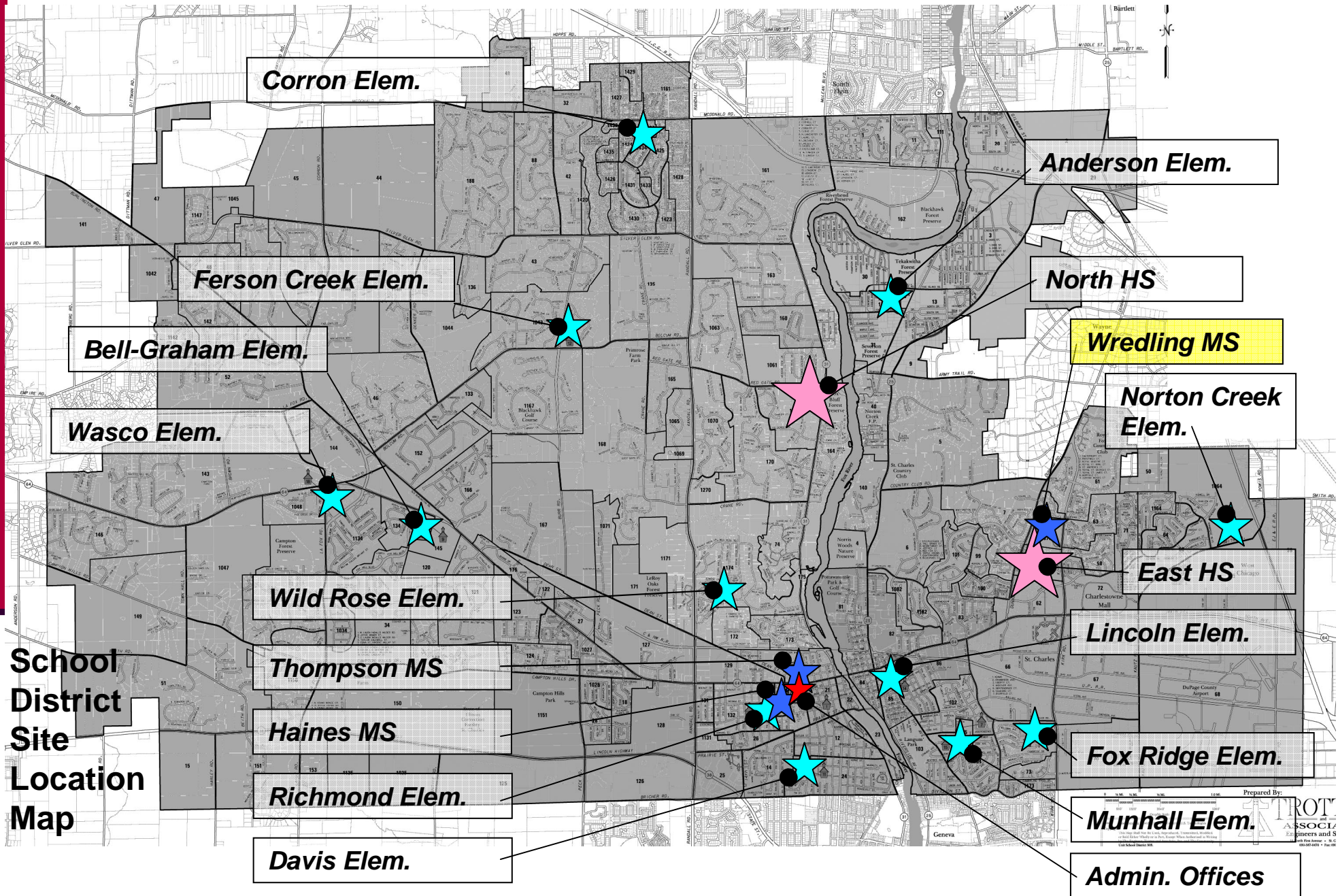

Wredling Middle School

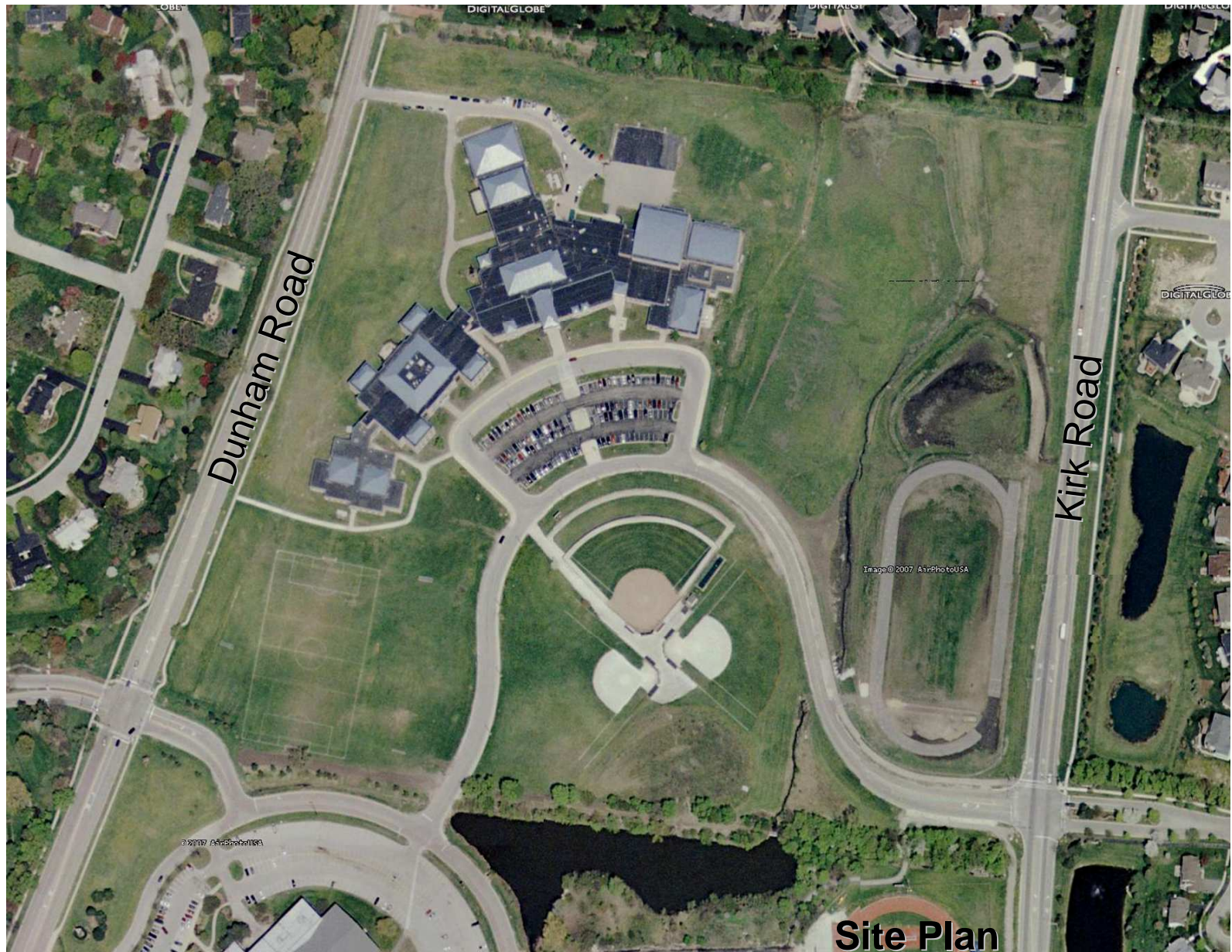

Site Plan

Feb 15 2008

Wredling Middle School

SITE:

40 Acres

SCP guidelines:
32 acres

BUILDING:

204,000 sf

1187 Students

172 sf / student

MDE guidelines:
150-180 sf / student

Built – 1995
Add'n – 2000

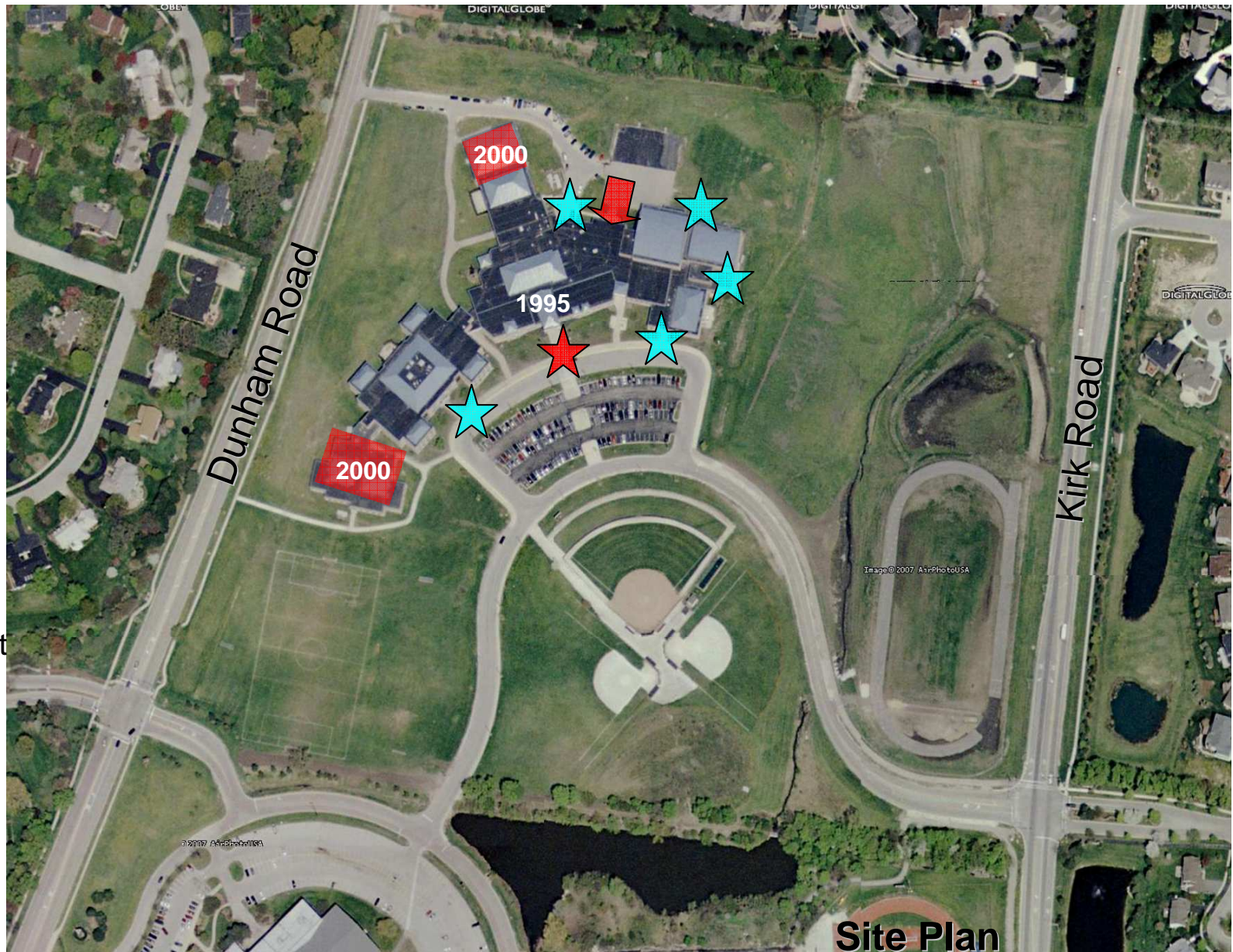

Feb 15 2008

Wredling Middle School

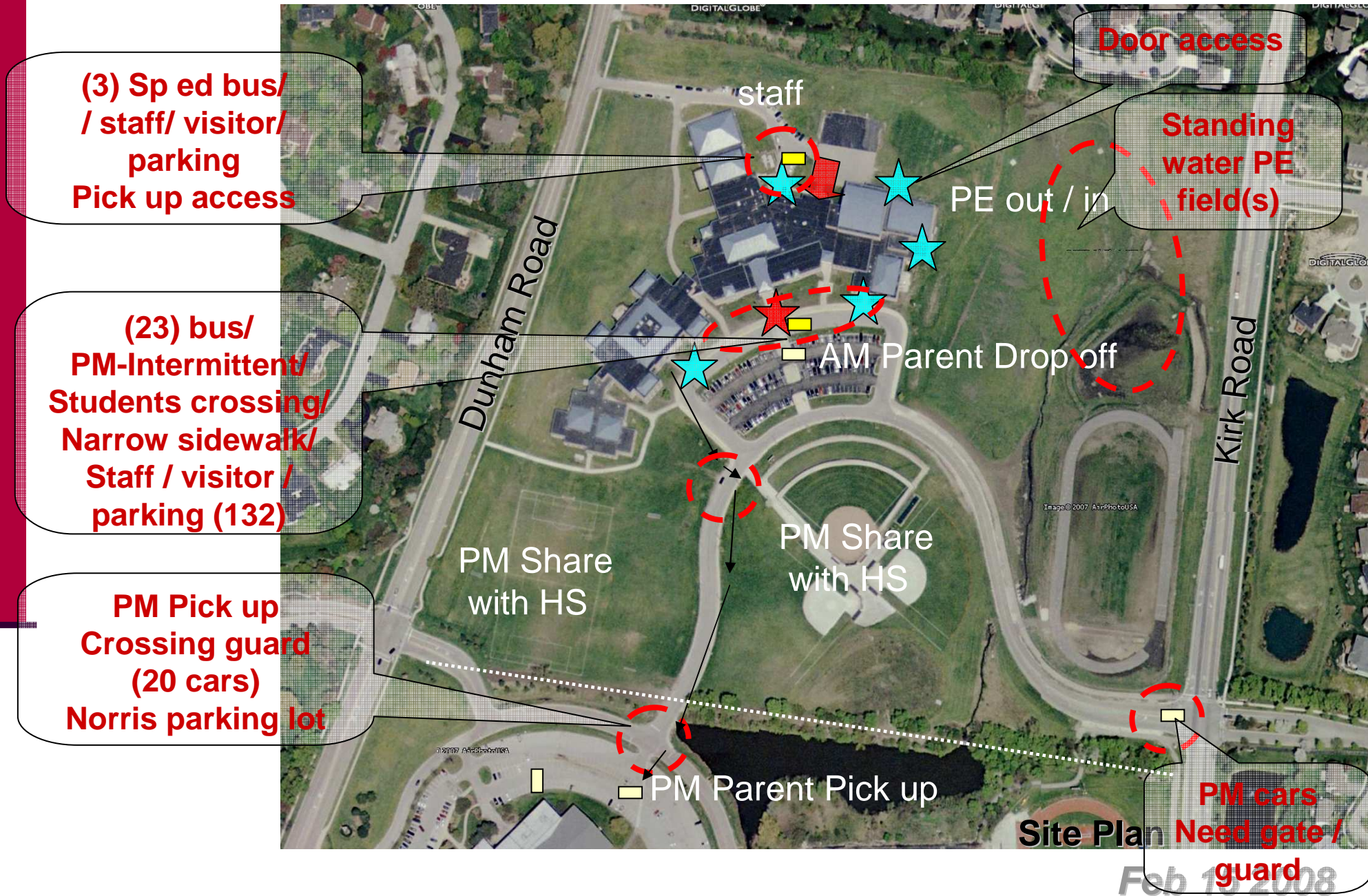

Wredling Middle School

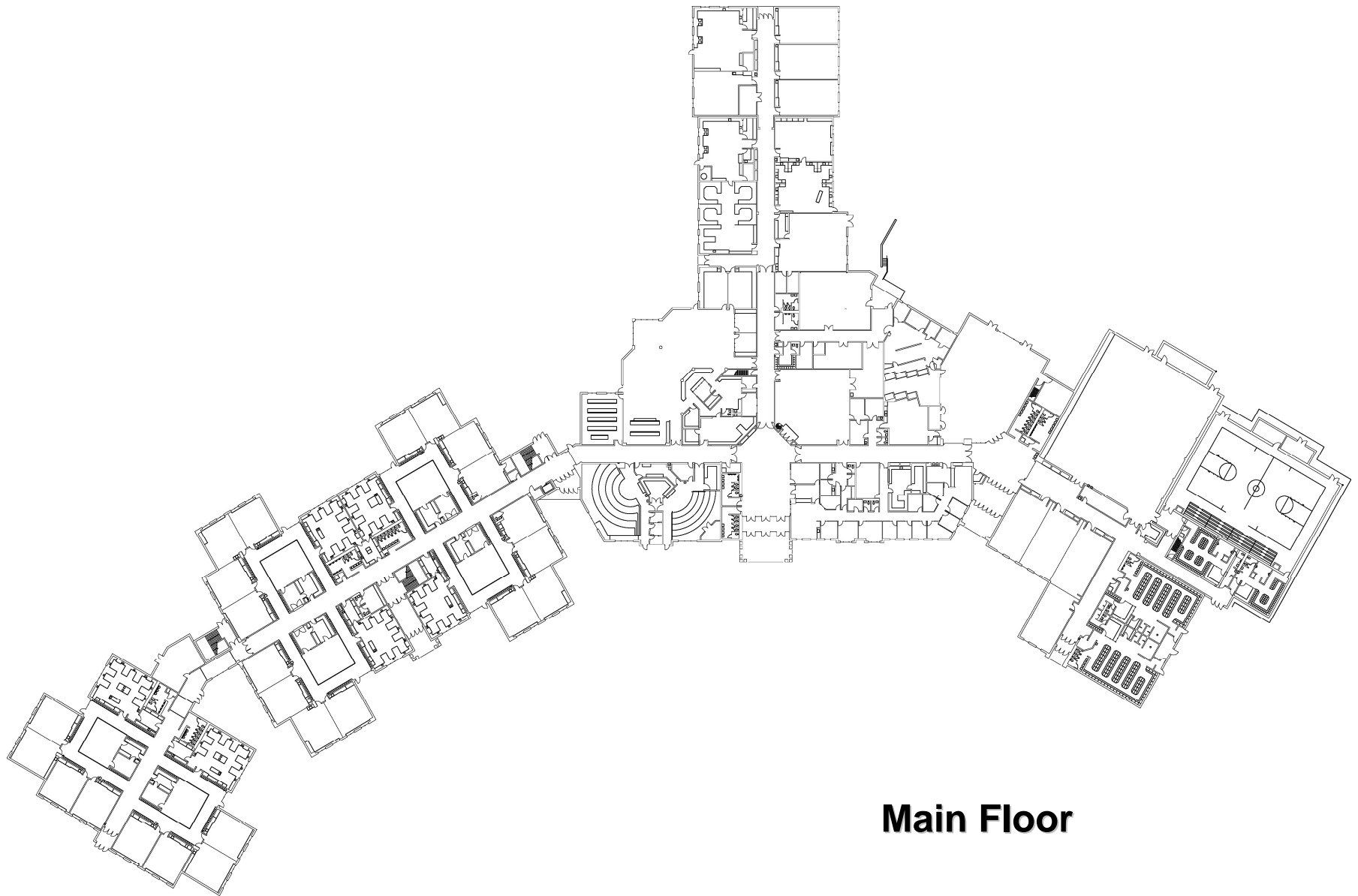

Main Floor

Wredling Middle School

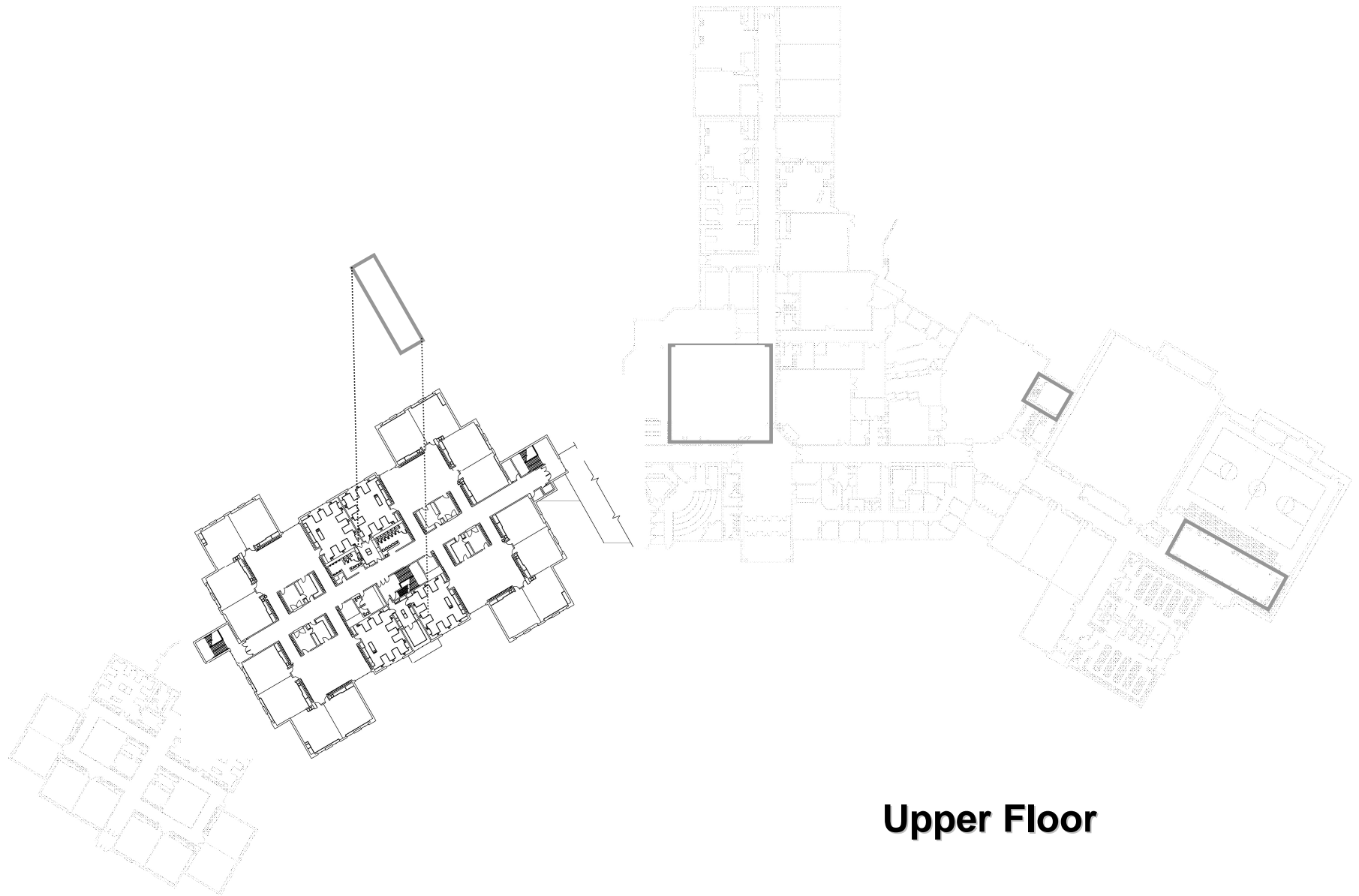

Upper Floor

Wredling Middle School

- CLASSROOM
- SPECIAL NEEDS
- COMM. / LANG. / HEALTH
- SCIENCE
- ART
- FACS
- MUSIC
- AUDITORIUM
- TECH. ED.
- P.E.
- MEDIA CENTER / COMP LAB
- STUDENT SERVICES
- FOOD SERVICE
- CENTER BASED PROGRAM
- MECH / ELEC
- FTLA / TEAM

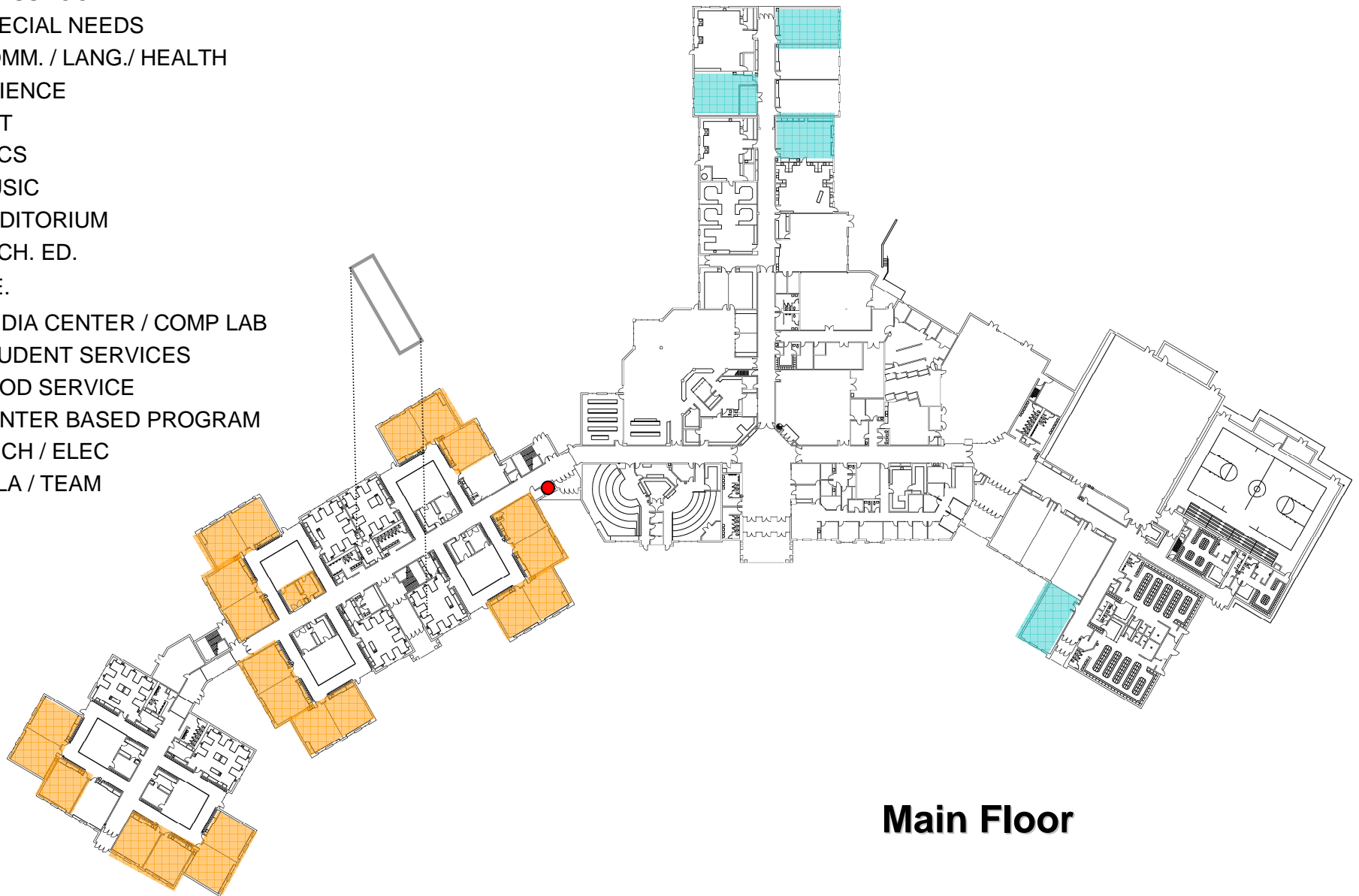

Main Floor

Wredling Middle School

-  CLASSROOM
-  SPECIAL NEEDS
-  COMM. / LANG. / HEALTH
-  SCIENCE
-  ART
-  FACS
-  MUSIC
-  AUDITORIUM
-  TECH. ED.
-  P.E.
-  MEDIA CENTER / COMP LAB
-  STUDENT SERVICES
-  FOOD SERVICE
-  CENTER BASED PROGRAM
-  MECH / ELEC
-  FTLA / TEAM

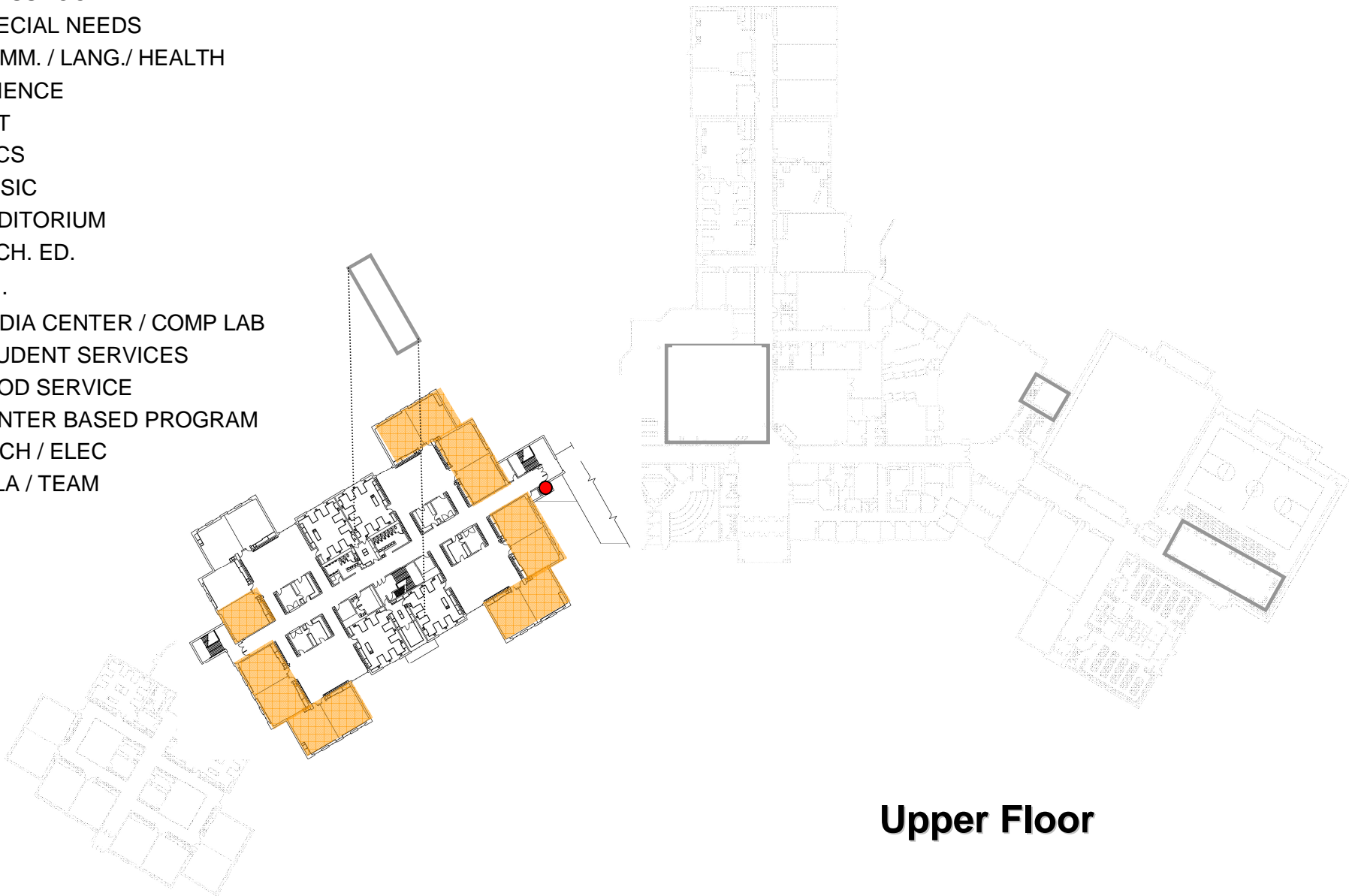

Upper Floor

Wredling Middle School

Teams: 9 (6-1 ...)
TS per team 4+1 (CORE)
Grades 6-8
Science 9 (10)
Classrooms 36 (general)
 45

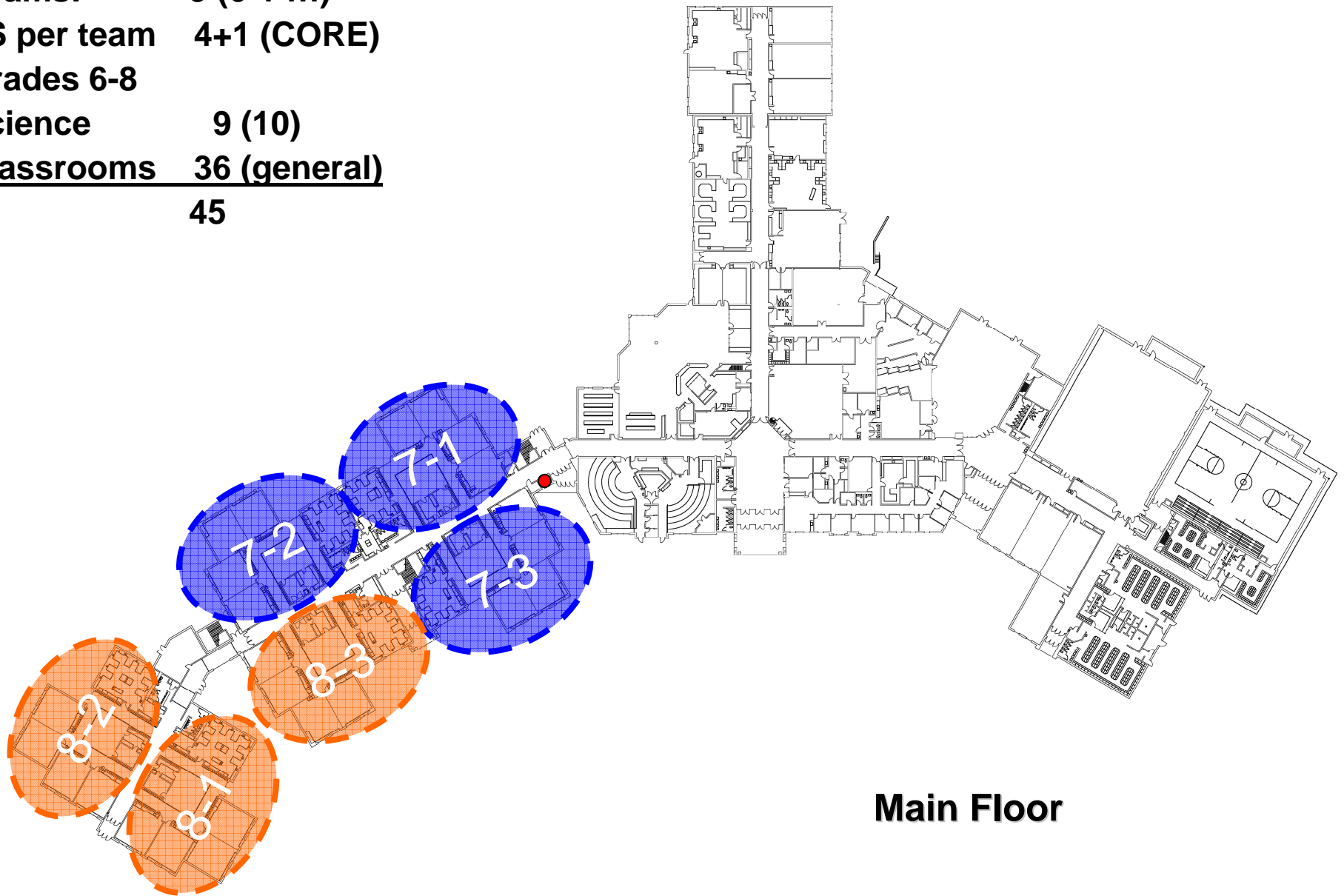

Main Floor



Upper Floor

Wredling Middle School

- CLASSROOM
- SPECIAL NEEDS
- COMM. / LANG. / HEALTH
- SCIENCE
- ART
- FACS
- MUSIC
- AUDITORIUM
- TECH. ED.
- P.E.
- MEDIA CENTER / COMP LAB
- STUDENT SERVICES
- FOOD SERVICE
- CENTER BASED PROGRAM
- MECH / ELEC
- FTLA / TEAM

All rooms with "0" are used 8 out of 8 (open periods noted).

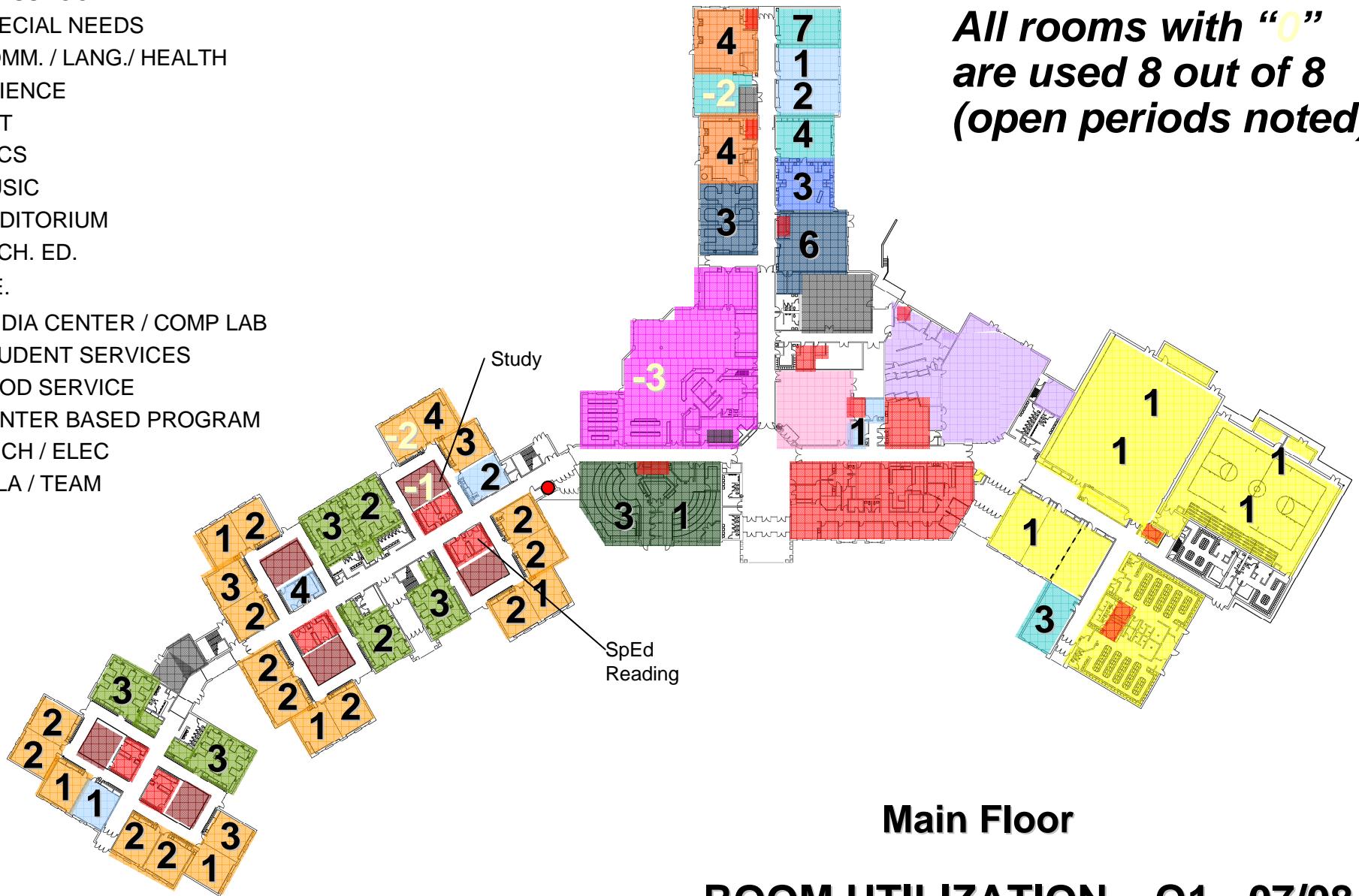

Main Floor

ROOM UTILIZATION – Q1 - 07/08

Feb 15 2008

Wredling Middle School

- CLASSROOM
- SPECIAL NEEDS
- COMM. / LANG. / HEALTH
- SCIENCE
- ART
- FACS
- MUSIC
- AUDITORIUM
- TECH. ED.
- P.E.
- MEDIA CENTER / COMP LAB
- STUDENT SERVICES
- FOOD SERVICE
- CENTER BASED PROGRAM
- MECH / ELEC
- FTLA / TEAM

**All rooms with "0"
are used 8 out of 8
(open periods noted).**

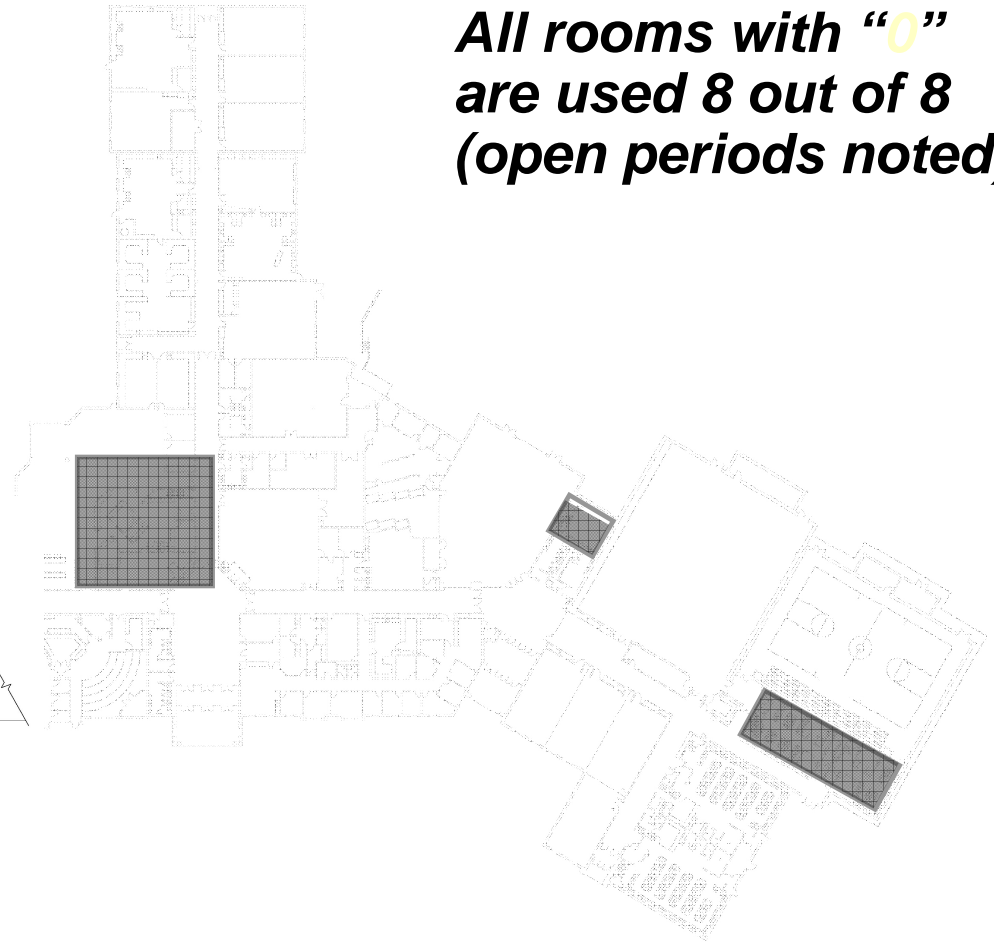
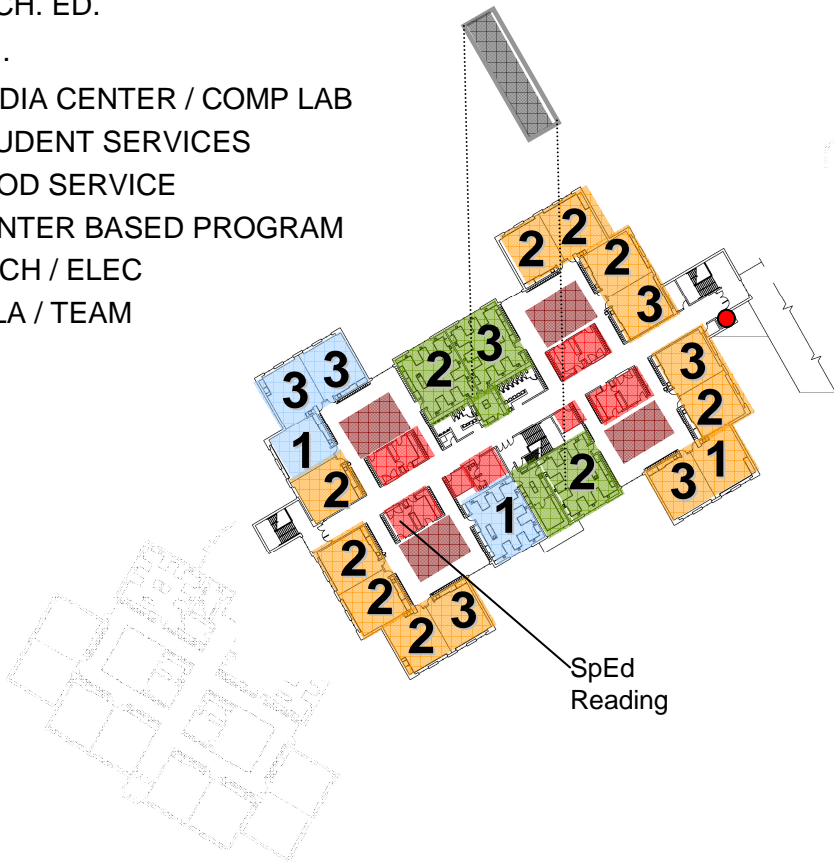

Upper Floor

ROOM UTILIZATION – Q1 - 07/08

Feb 15 2008

Wredling Middle School

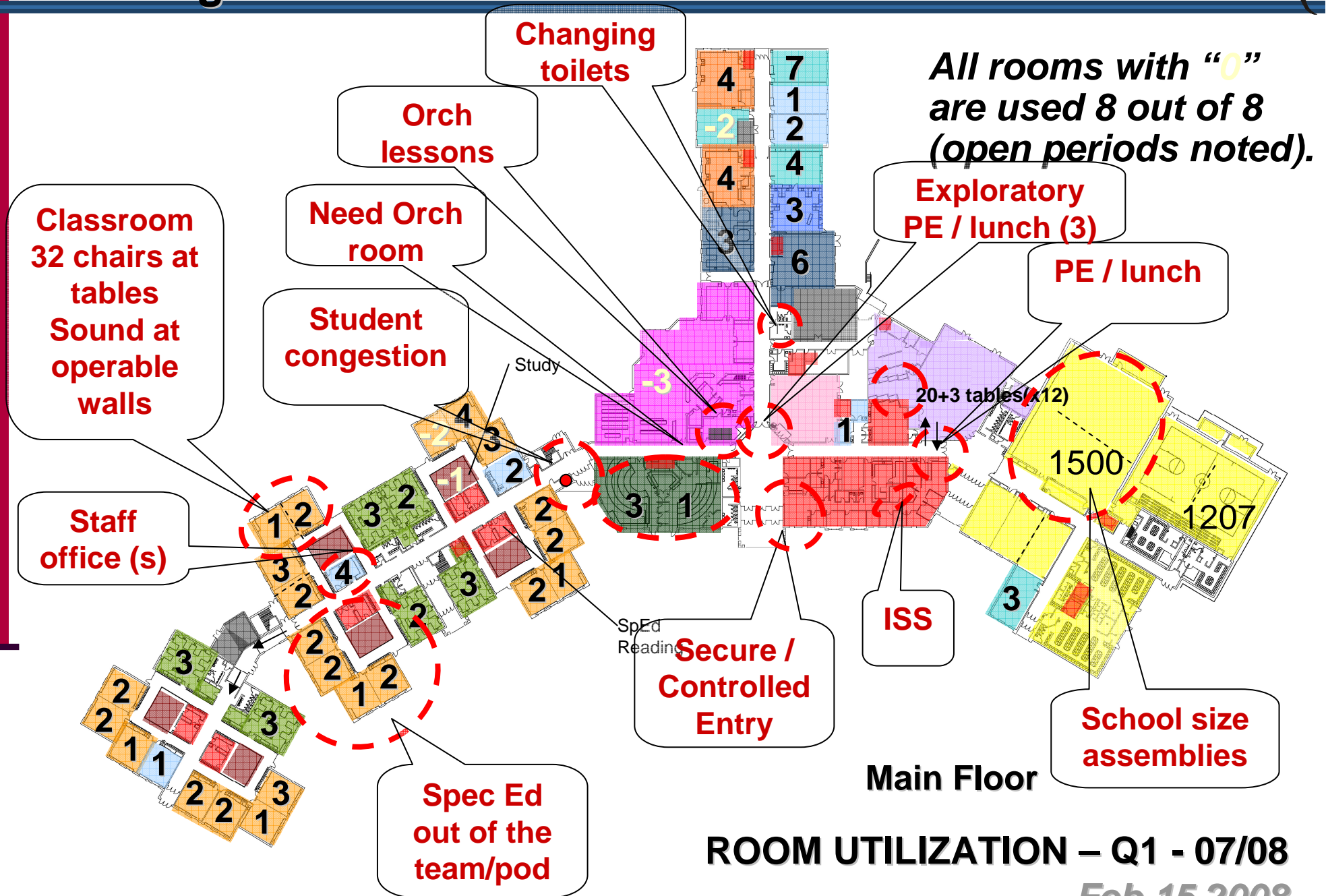

ROOM UTILIZATION – Q1 - 07/08

Feb 15 2008

Wredling Middle School

- CLASSROOM
- SPECIAL NEEDS
- COMM. / LANG. / HEALTH
- SCIENCE
- ART
- FACS
- MUSIC
- AUDITORIUM
- TECH. ED.
- P.E.
- MEDIA CENTER / COMP LAB
- STUDENT SERVICES
- FOOD SERVICE
- CENTER BASED PROGRAM
- MECH / ELEC
- FTLA / TEAM

**All rooms with "0"
are used 8 out of 8
(open periods noted).**

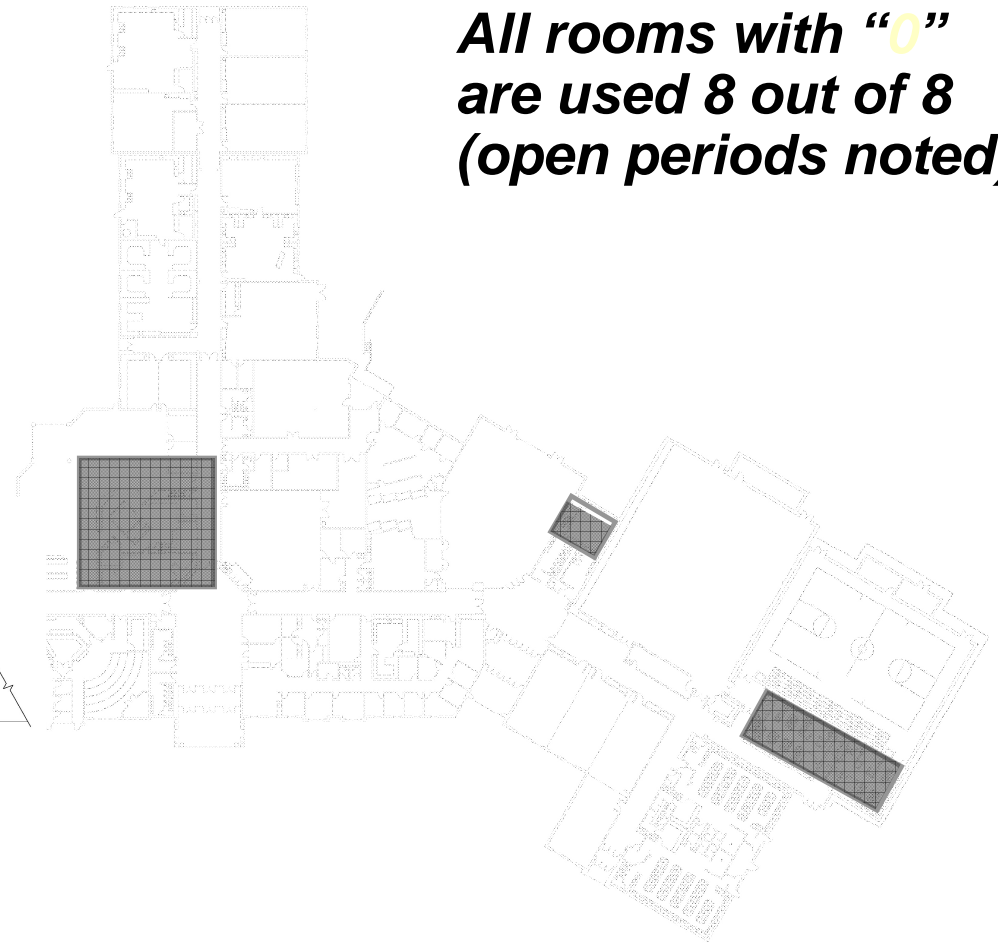
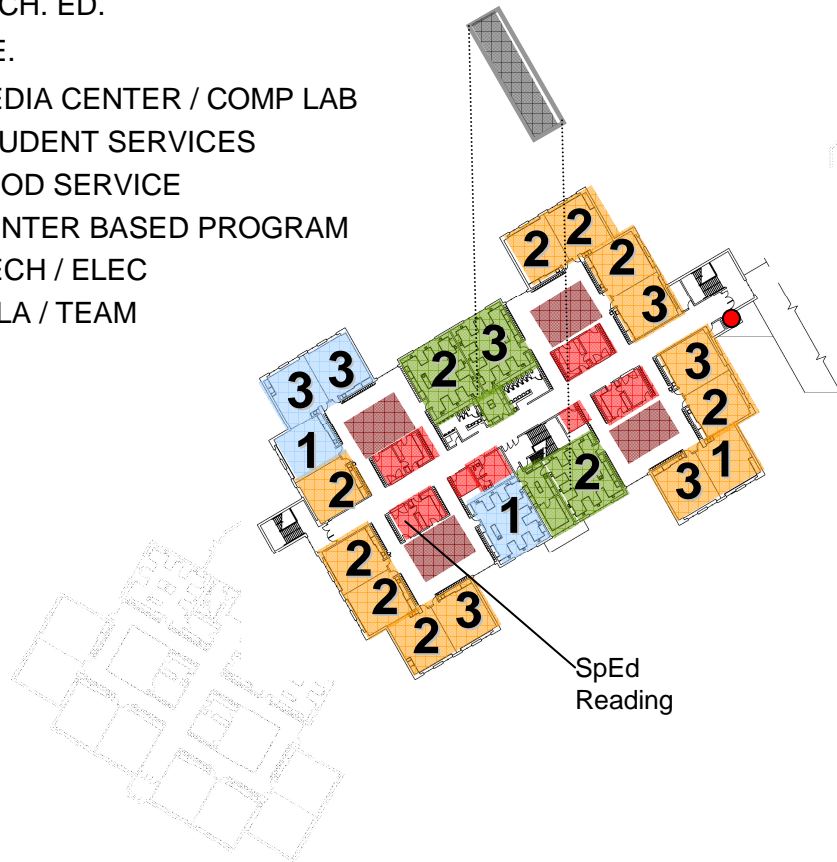

Upper Floor

ROOM UTILIZATION – Q1 - 07/08

Feb 15 2008

KINDERGARTEN ROOMS

Square Footage

1,600
1,500
1,400
1,300
1,200
1,100
1,000
900
800
700
600

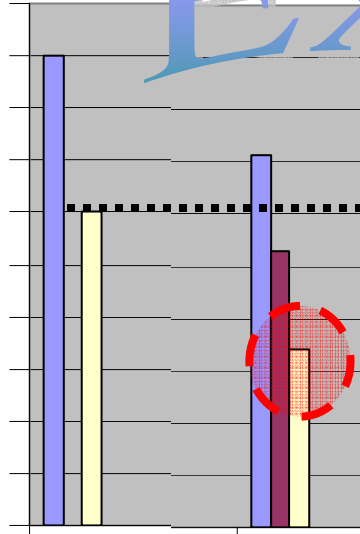

MDE

Davis (K-5)

Example

HIGH
TYPICAL
LOW

	1,509	1,314	1,392
	1,509	1,127	1,392
	1,509	940	1,392

	2	1,509	1	1,314	2	1,392
1,200 sf or large						
Less than 1,200 s			1	940		

TOTAL 2 3,018 2 2,254 2 2,784

CLASSROOMS: GENERAL / SP.ED.– MIDDLE SCHOOLS

	CLASSROOM			SPEC SERVICES			MISC			TEAM LEARNING		
	Haines MS	Thompson MS	Wredling MS	Haines MS	Thompson MS	Wredling MS	Haines MS	Thompson MS	Wredling MS			
HIGH	950	1,244	881	735	1,200	778	602	1,080	1,100	-	-	-
TYPICAL		796	709	734	800	707	488	723		#DIV/0!	#DIV/0!	#DIV/0!
LOW	850	644	514	726	450	565	362	184	850	-	-	-
	1	1,244										
	1	1,113										

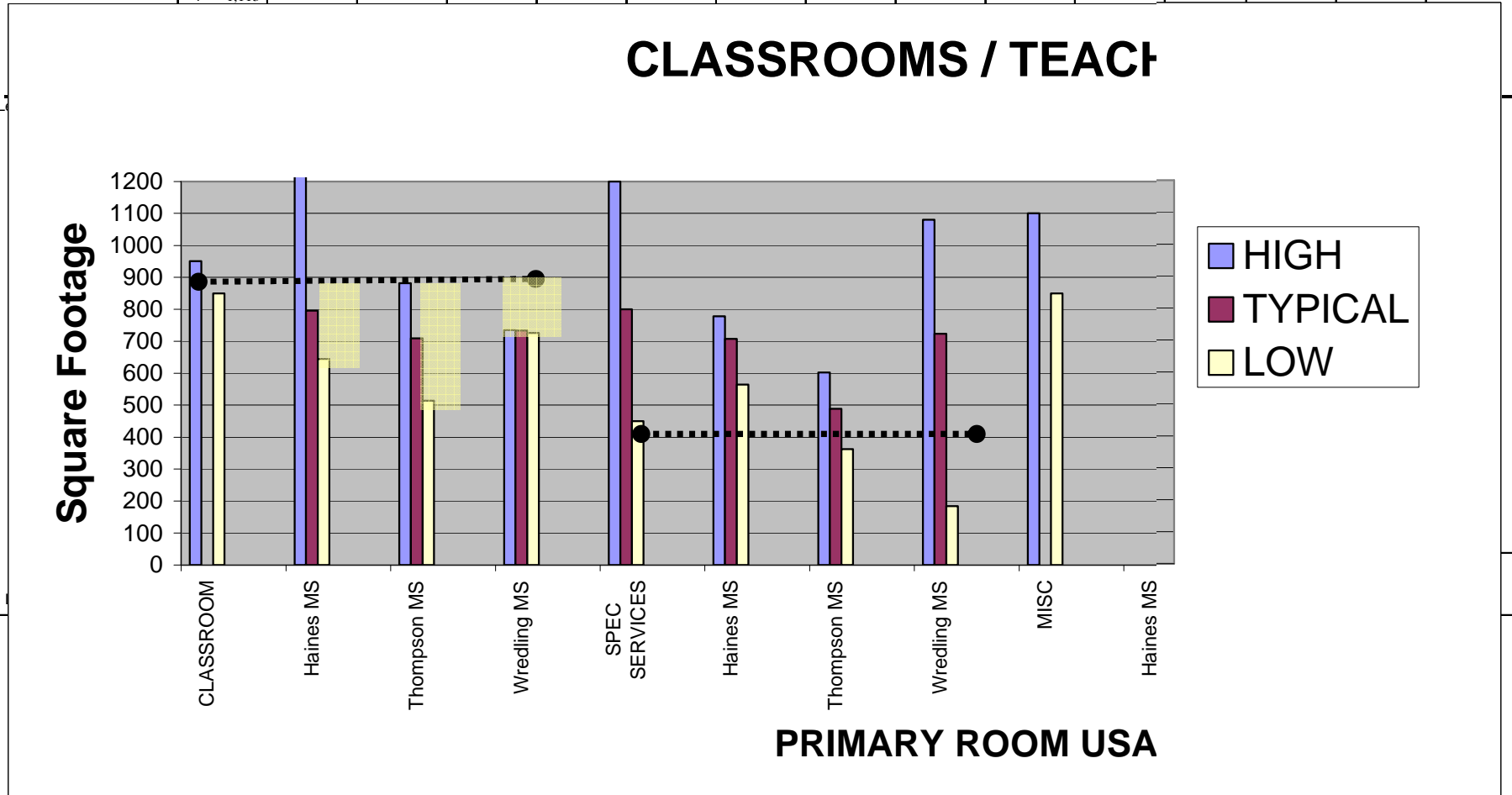

St Charles District 303

ART ROOMS – MIDDLE SCHOOLS

	MULTILAB			STORAGE			3D(CERAMICS)		
	Haines MS	Thompson MS	Wredling MS	Haines MS	Thompson MS	Wredling MS	Haines MS	Thompson MS	Wredling MS
HIGH	1,500	-	1,601	300	754	-	1,936	1,288	1,320
TYPICAL	#DIV/0!	#DIV/0!	1,601	#DIV/0!	754	#DIV/0!	1,936	1,288	1,320
LOW	1,200	-	1,601	-	754	-	1,936	1,288	1,320

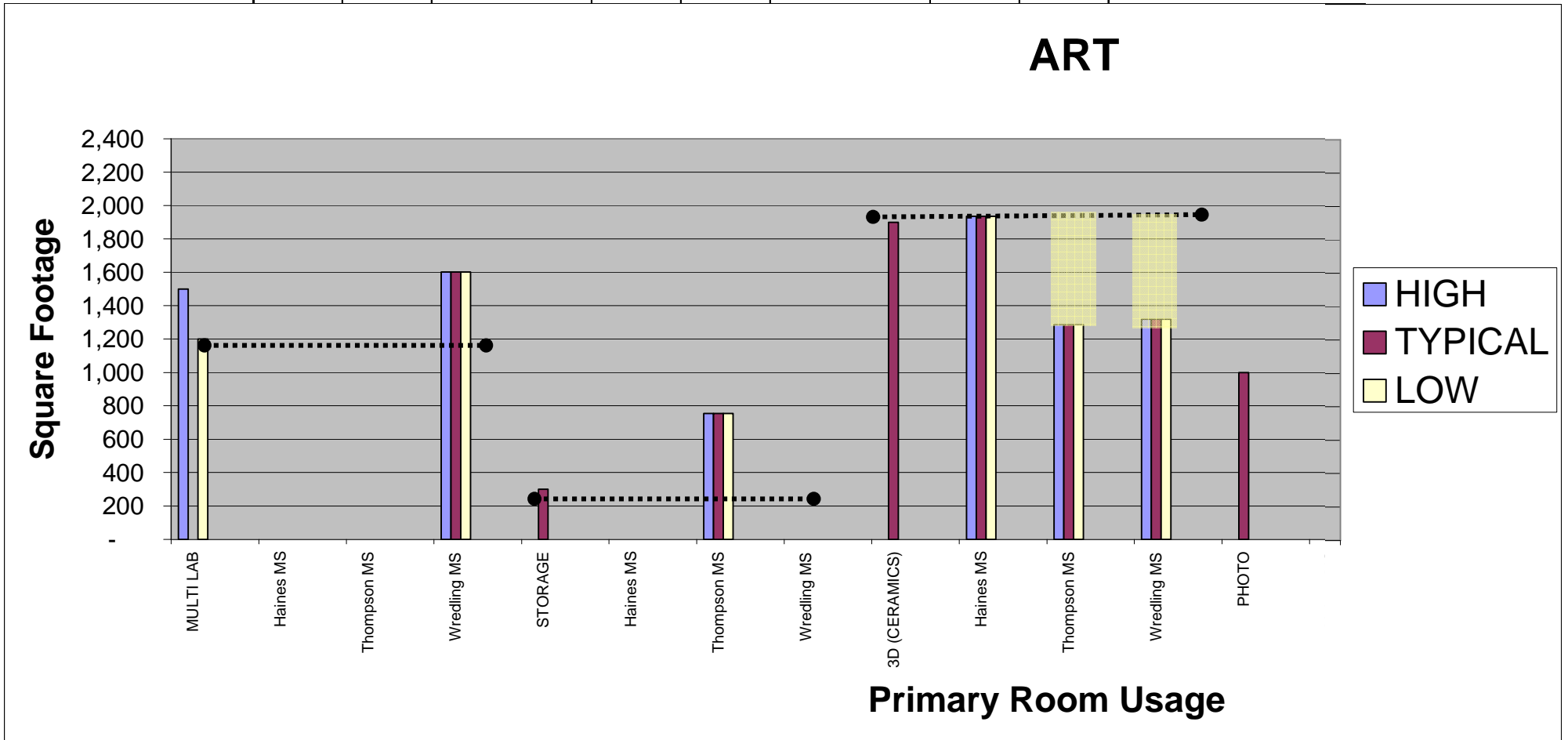

St Charles District 303

TECHNOLOGY EDUCATION – MIDDLE SCHOOLS

	TECH LAB			GENERAL			CADD/GRAPHICS		
	Haines MS	Thompson MS	Wredling MS	Haines MS	Thompson MS	Wredling MS	Haines MS	Thompson MS	Wredling MS
HIGH									
TYPICAL	1,441	2,446	2,000	1,833	2,128	1,800	1,384	728	1,036
LOW							1,248		1,021

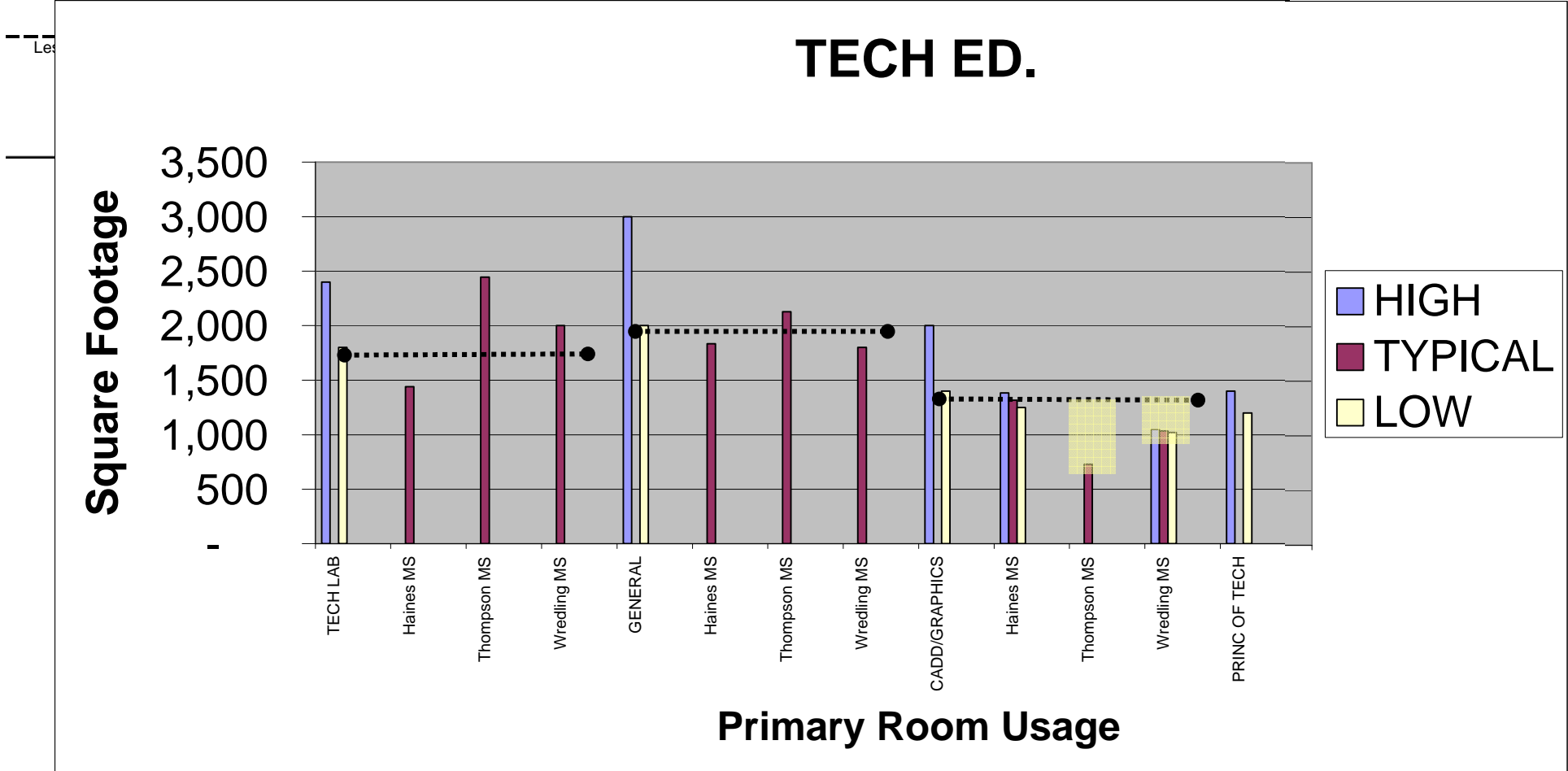

St Charles District 303

SCIENCE LABS – MIDDLE SCHOOLS

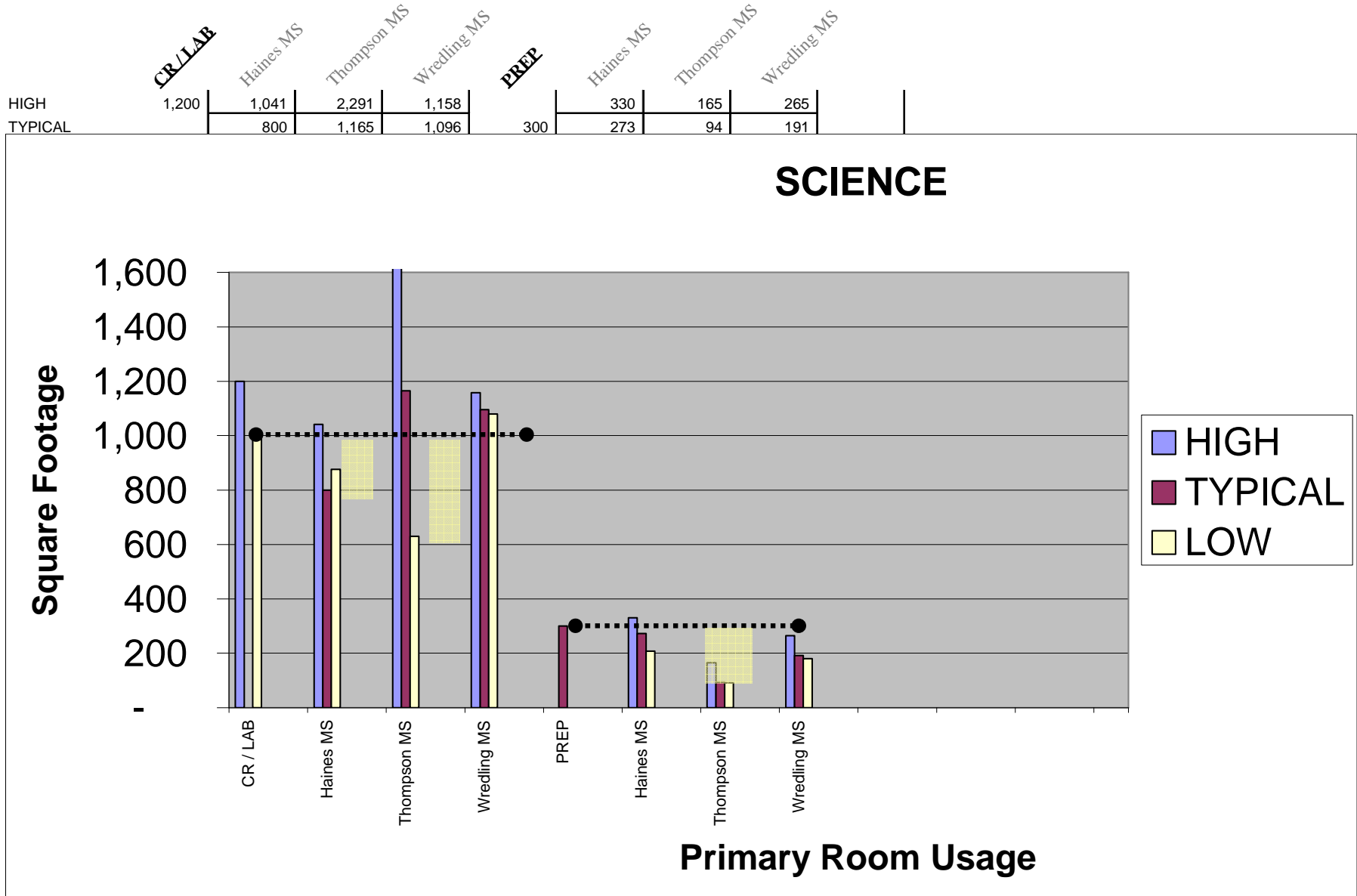

NOTES: .1 Wredling Sci lab used for general instruction

St Charles District 303

MUSIC ROOMS – MIDDLE SCHOOLS

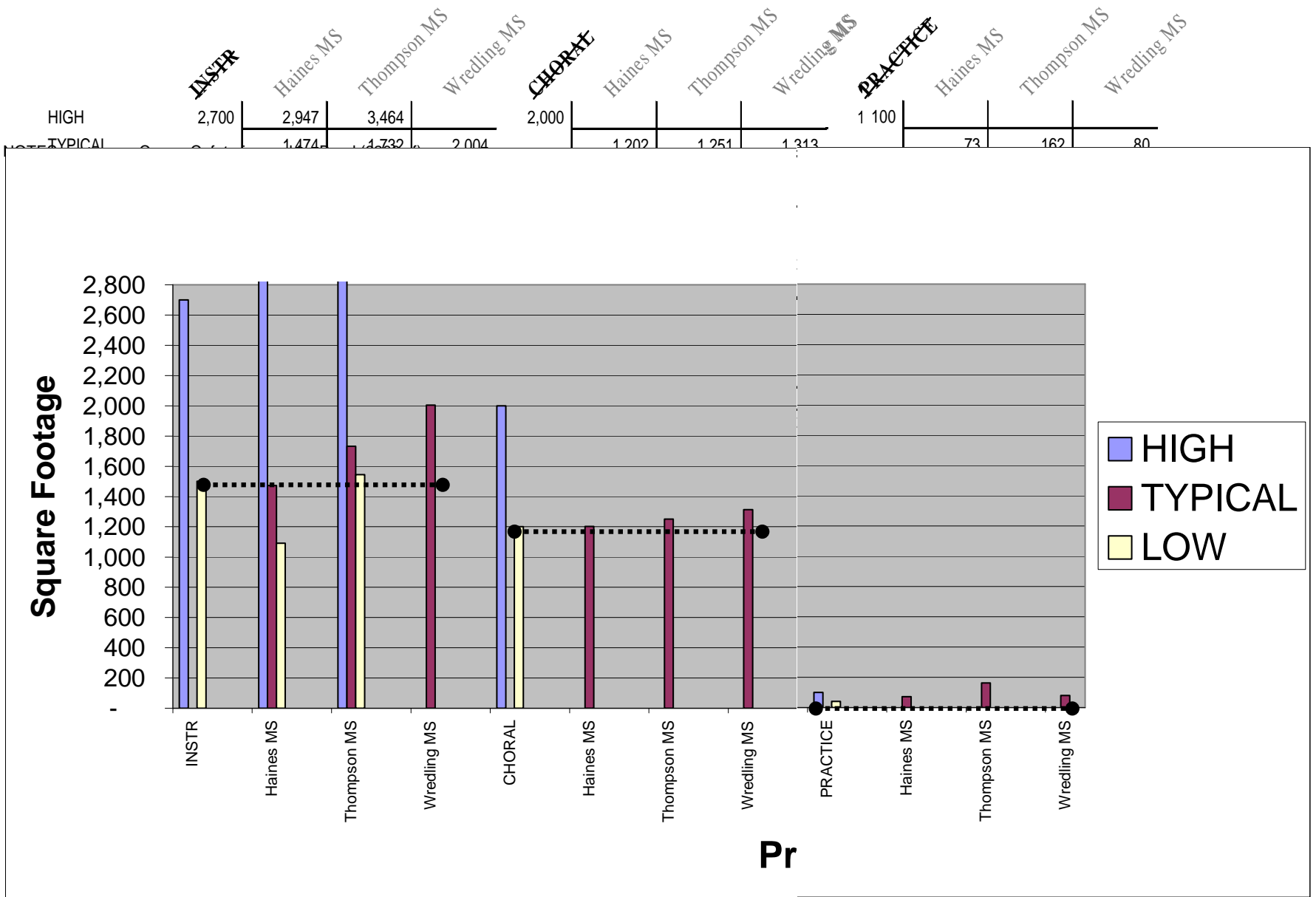

St Charles District 303

PHYSICAL EDUCATION / ATHLETICS – MIDDLE SCHOOLS

	(1) GYM	Haines MS	Thompson MS	Wredling MS	WEIGHTS	Haines MS	Thompson MS	Wredling MS	P.E. LKRS	Haines MS	Thompson MS	Wredling MS	ATHLETIC LKRS	Haines MS	Thompson MS	Wredling MS
HIGH	7,000	10,170	10,504	9,000	-	2,146	2,248	2,248	2,546	1,383	1,440	1,440	1,500	-	1,440	600
TYPICAL		4,920	6,325	8,121	#DIV/0!	1,793	2,248	2,248	2,149	1,335	1,440	1,440	#DIV/0!	1,440	463	463
					-	1,440	2,248	2,248	1,751	1,286	1,440	1,440	1,000	-	1,440	326

P.E. / ATHLETICS

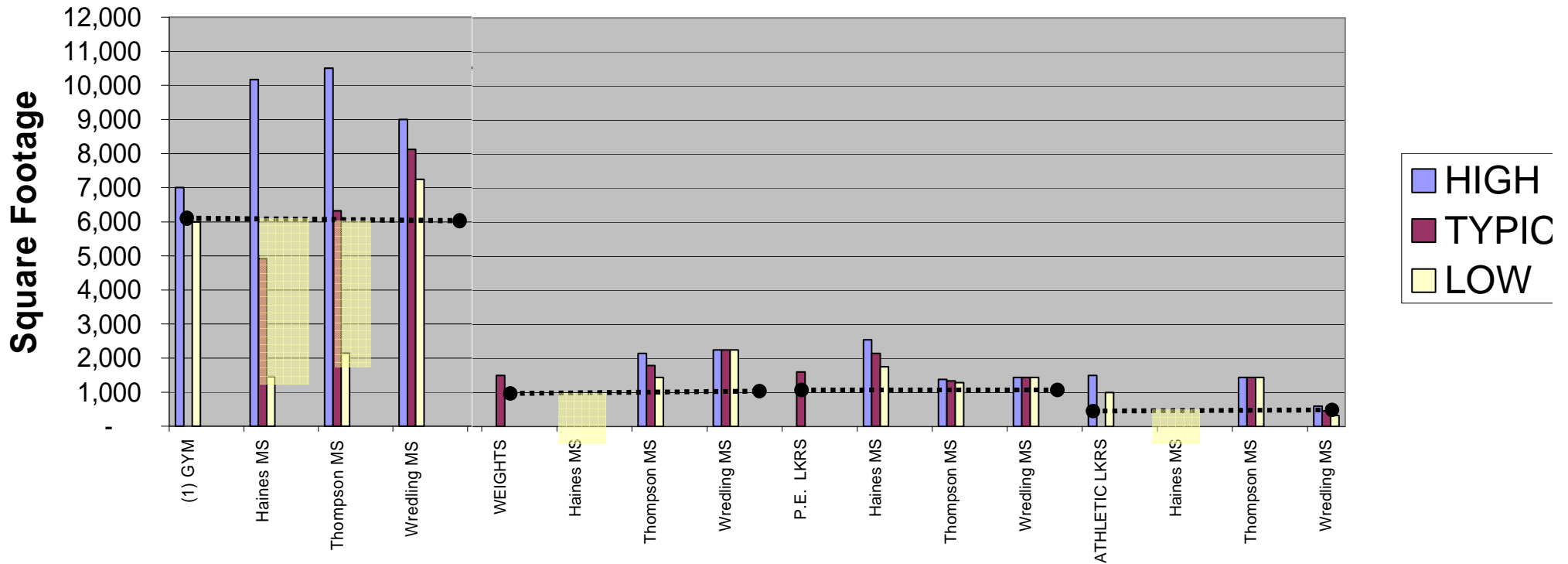

St Charles District 303

Agenda...

- Introduction
- Approach to Evaluation
- Building utilization review
- **Small group activity**
- Reporting / Prioritization

Main themes from groups at Summit 303 meeting on facilities (Mar 13)

- Safety and Security
- Increase Classrooms / class size - crowding
- Indoor air quality
- ADA / accessibility
- Space for programs / future needs

Your Input...

- List the sources of pride and strengths of **Wredling Middle School**.

- List **facility** improvements (needs) that should be made for **Wredling Middle School**.

Record:

All of the group's reported areas of strengths and needs.

Group Prioritize:

Identify the three (3) most significant needs.

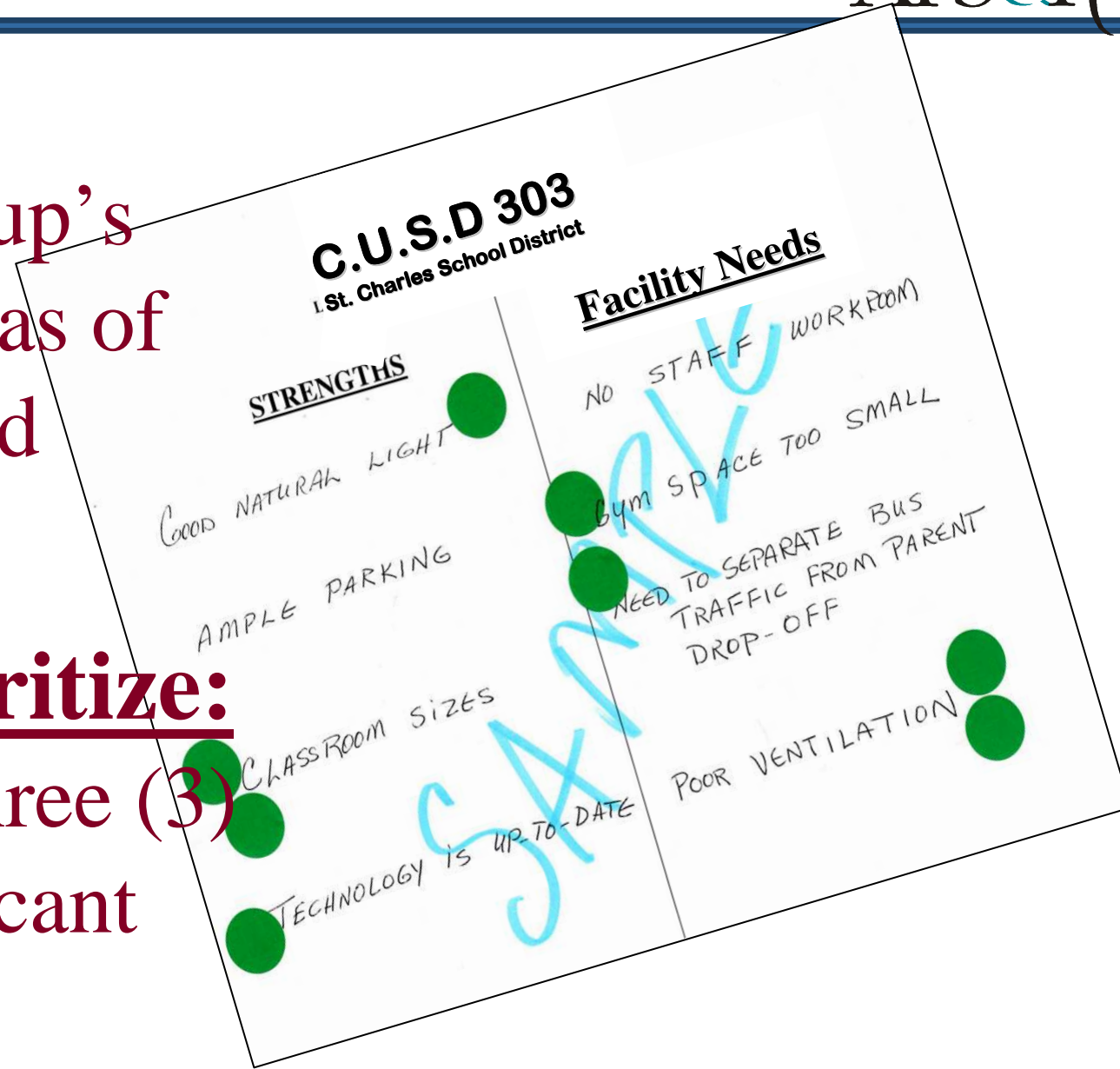

List the sources of pride and strengths of Wredling Middle School

- Building layout with PODS / FTLA to support Middle School Program
- Modern facility – PODS, Air conditioning, Natural light

Identify the top 5 facility improvements/ needs that should be made for Wredling Middle School

1. Special Education classrooms within teams / PODS (8)
2. Size of classroom / for # of students (5)
3. Teacher to have their own classroom / no teachers on carts (S.S., Spec. Ed., Foreign Lang.) (5)
4. Improve drainage at NE play field/football field (3)
5. Separation of buses & student drop-off / better system for parent traffic drop-off (3)

(the number in parenthesis () indicates the number of votes received during the prioritization process)

Other:

- Orchestra room / instructor storage (0)

(the number in parenthesis () indicates the number of votes received during the prioritization process)

Thank You...